

安裝尺寸 mm(英寸)

接線盒型

D8-02-※-※-35(35C)

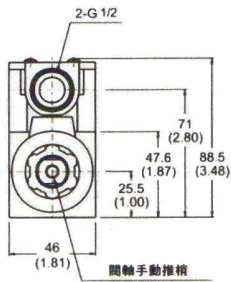

35交流(AC電磁線圈)
35C(AC/DC電磁線圈)

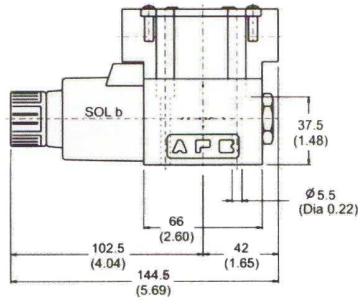

35交流(AC電磁線圈)
35C(AC/DC電磁線圈)

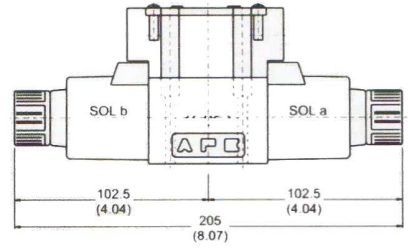

35交流(AC電磁線圈)
35C(AC/DC電磁線圈)

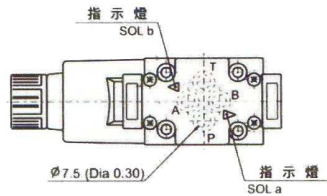

35DC(電磁線圈)

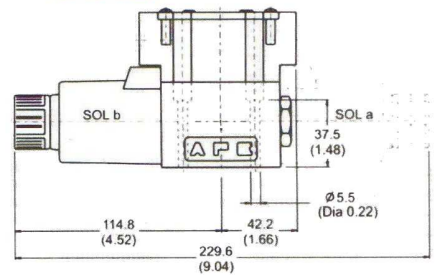

DIN插頭型

D9-02-※-※-35(35C)

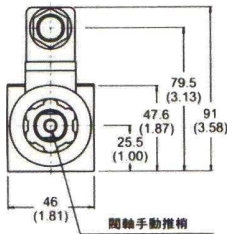

35交流(AC電磁線圈)
35C(AC/DC電磁線圈)

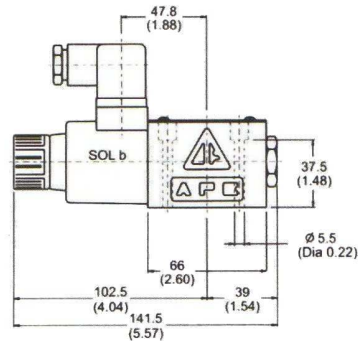

35交流(AC電磁線圈)
35C(AC/DC電磁線圈)

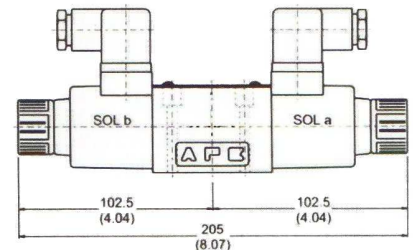

35交流(AC電磁線圈)
35C(AC/DC電磁線圈)

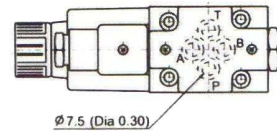

35DC(電磁線圈)

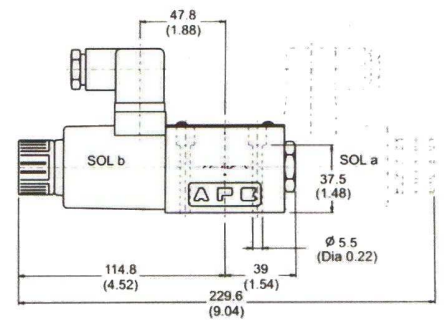

安裝尺寸 mm(英寸)

接線盒型

D8-03-※-※-35

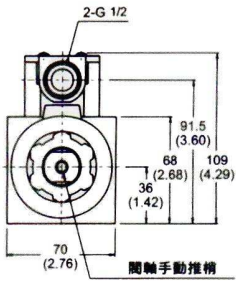

交流電磁綫圈

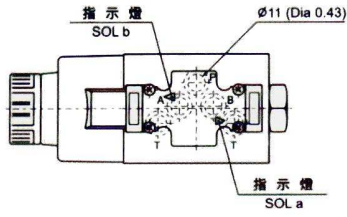

交流電磁綫圈

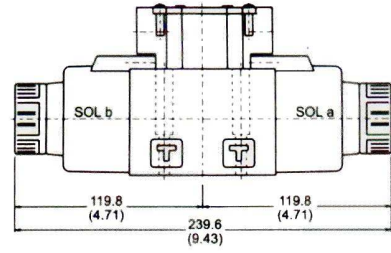

交流電磁綫圈

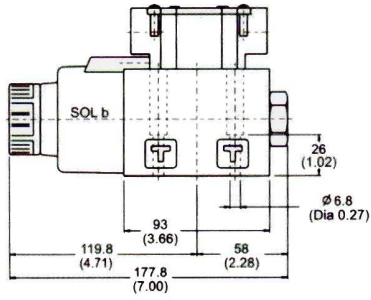

直流電磁綫圈

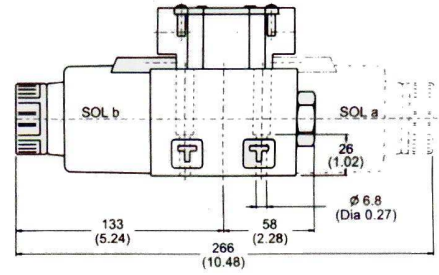

DIN插頭型

D9-03-※-※-35(35C)

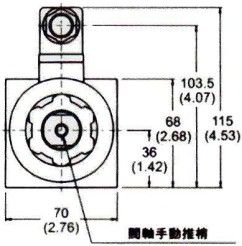

交流電磁綫圈

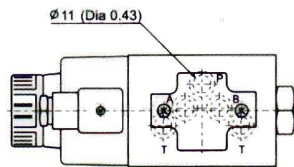

交流電磁綫圈

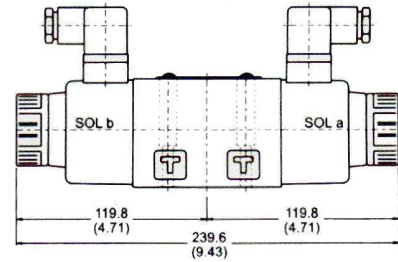

交流電磁綫圈

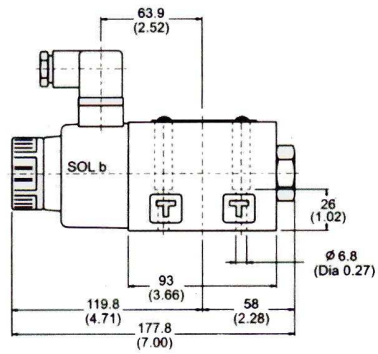

直流電磁綫圈

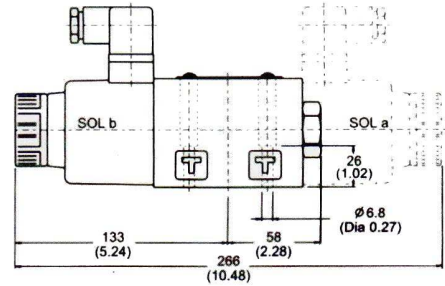

安裝尺寸 mm(英寸)

接線盒型 D8-03-※-※-35H

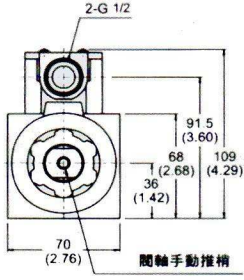

閥軸手動推柄

DIN插頭型 D9-03-※-※-35H

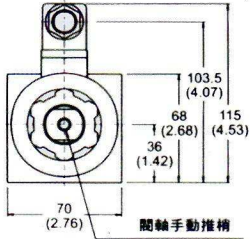

閥軸手動推柄

交流電磁線圈

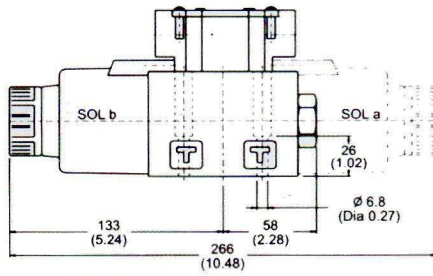

直流電磁線圈

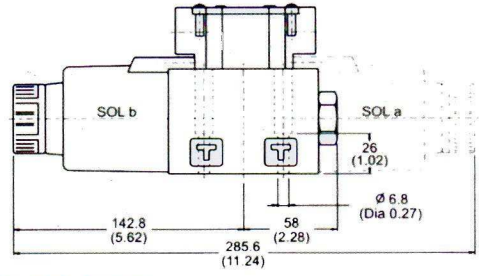

交流電磁線圈

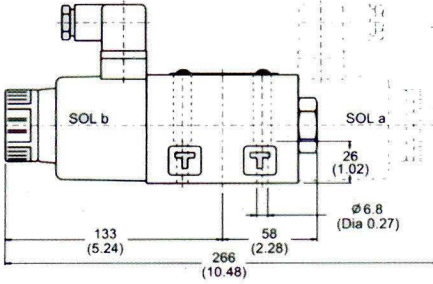

直流電磁線圈

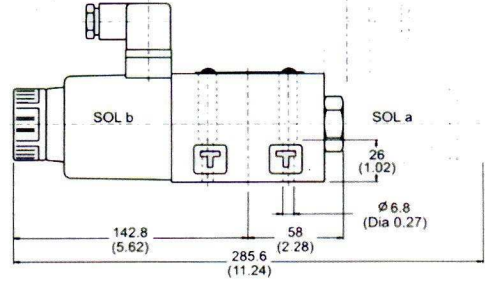

底板尺寸 mm(英寸)

For D8/D9-02-35系列

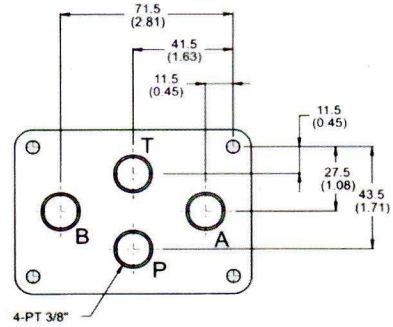
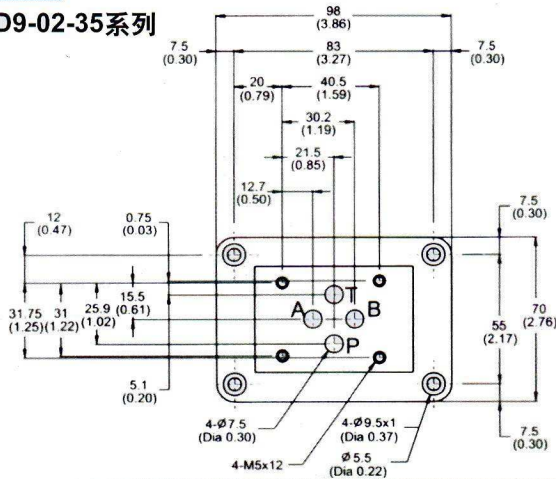

For D8/D9-03-35(H)系列

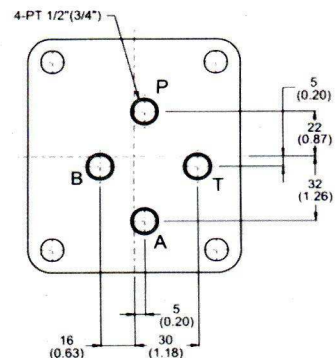
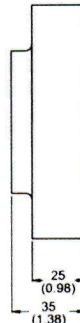
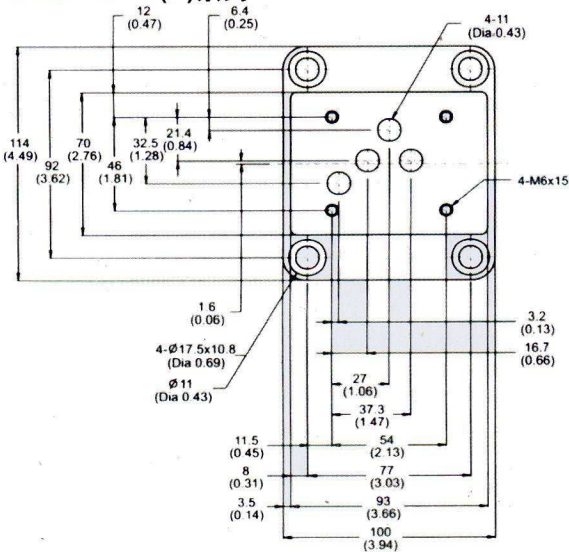

備注:

可安裝外加T孔以減低壓力降 (底板設計成雙回油口獨自回油)

Installation Dimensions mm(inch)

Joint Box Type

D8-02-※-※-35

AC solenoid

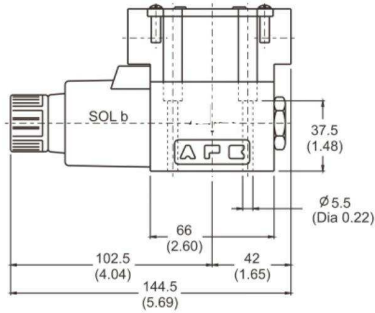

AC solenoid

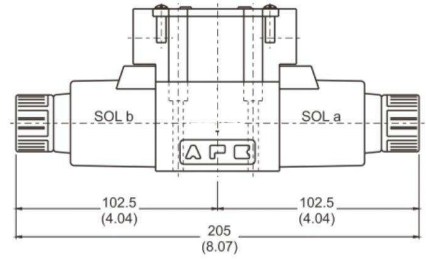

AC solenoid

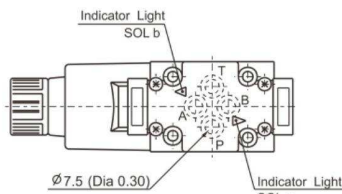

DC solenoid

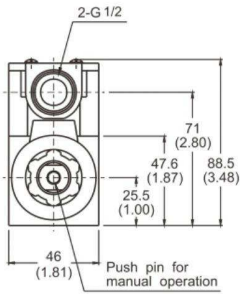
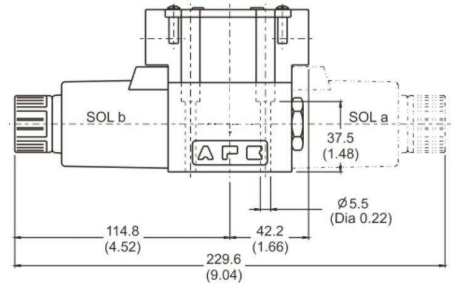

DIN Type

D9-02-※-※-35

AC solenoid

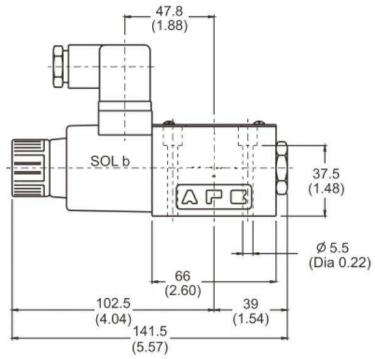

AC solenoid

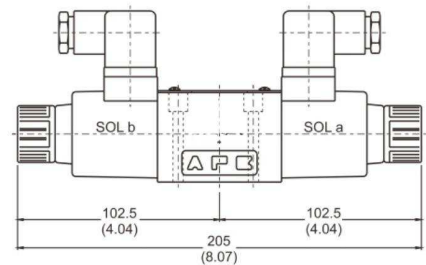

AC solenoid

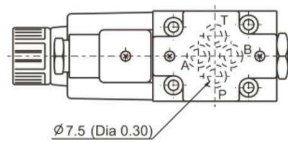

DC solenoid

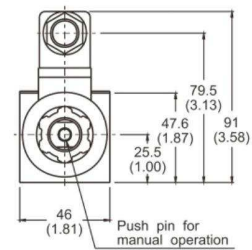
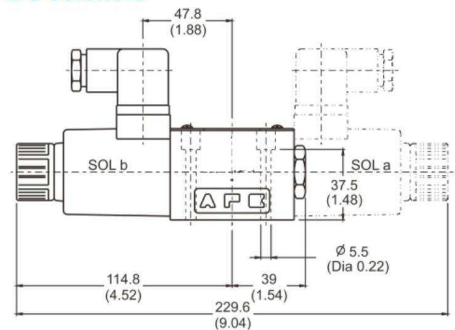

Installation Dimensions mm(inch)

Joint Box Type

D8-03-※-※-35

AC solenoid

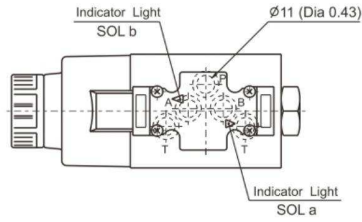

AC solenoid

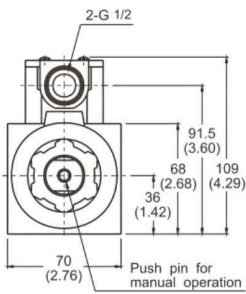
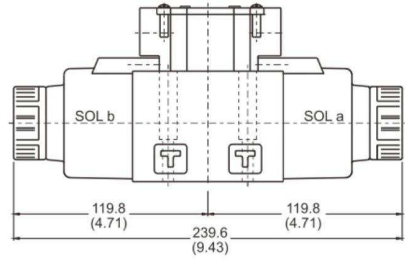

AC solenoid

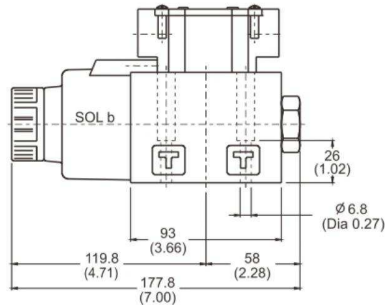

DC solenoid

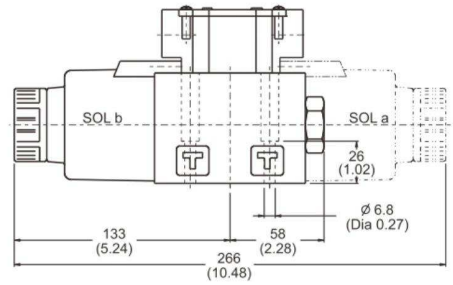

DIN Type

D9-03-※-※-35

AC solenoid

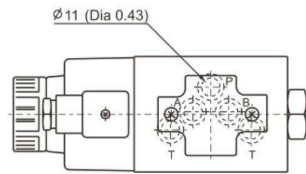

AC solenoid

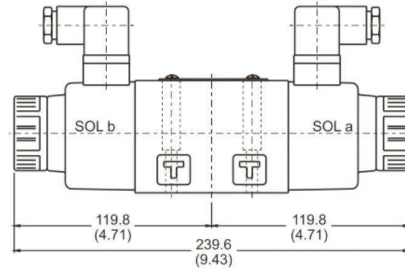

AC solenoid

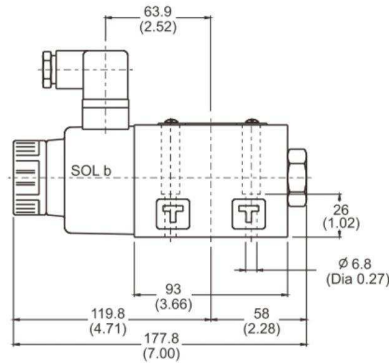

DC solenoid

